

# Flat gaskets

for cable entry frames

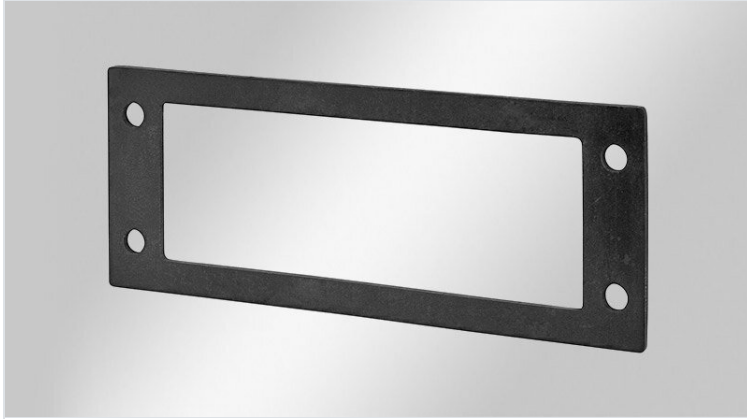

A flat gasket is provided to ensure a clean seal between the cable entry frame and the enclosure / control panel wall. Although this gasket is included in delivery, it can also be ordered separately. The standard gaskets for our KEL cable entry frames are self-adhesive on one side. This facilitates the alignment and assembly of the gasket.

## Advantages & benefits

- Clean seal between the cable entry frame and the enclosure / control panel wall
- Self-adhesive for easier alignment and assembly

## Product types & sizes

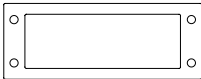
<b>Gasket 24</b>	Part No.	<b>42246</b>	Cut-out size	<b>112 × 36 mm</b>
	EAN	<b>4251269332647</b>	No. of screw holes	<b>4</b>
	Package quantity	<b>10</b>	Diam. of screw holes	<b>6 mm</b>
	Length	<b>145 mm</b>	Colour	<b>black</b>
	Width	<b>56 mm</b>	Suitable for cable entry systems:	<b>KEL 24, KEL-U 24, KEL-ER 24, KEL-QUICK 24, KEL-FG-A, KEL-FG-ER A</b>
	Height	<b>2,5 mm</b>		
	Mounting height	<b>2,5 mm</b>		

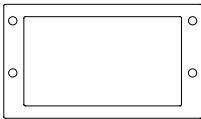
<b>Gasket 24-E</b>	Part No.	<b>42254</b>	Cut-out size	<b>112 × 66 mm</b>
	EAN	<b>4251269332678</b>	No. of screw holes	<b>4</b>
	Package quantity	<b>1</b>	Diam. of screw holes	<b>6 mm</b>
	Length	<b>143 mm</b>	Colour	<b>black</b>
	Width	<b>83 mm</b>	Suitable for cable entry systems:	<b>KEL 24-E</b>
	Height	<b>3 mm</b>		
	Mounting height	<b>3 mm</b>		

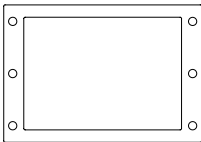
<b>Gasket 24-MT</b>	Part No.	<b>42253</b>	Cut-out size	<b>112 × 82 mm</b>
	EAN	<b>4251269332661</b>	No. of screw holes	<b>6</b>
	Package quantity	<b>1</b>	Diam. of screw holes	<b>6 mm</b>
	Length	<b>143 mm</b>	Colour	<b>black</b>
	Width	<b>100 mm</b>	Suitable for cable entry systems:	<b>KEL 24-MT</b>
	Height	<b>3 mm</b>		
	Mounting height	<b>3 mm</b>		

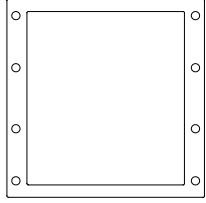
**Gasket 24-2MT**

Part No. **42255**  
 EAN **4251269332685**  
 Package quantity **1**  
 Length **143 mm**  
 Width **144,5 mm**  
 Height **3 mm**  
 Mounting height **3 mm**

Cut-out size **112 × 126 mm**  
 No. of screw holes **8**  
 Diam. of screw holes **6 mm**  
 Colour **black**  
 Suitable for cable entry systems: **KEL 24-2MT**

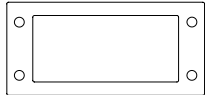
**Gasket 16**

Part No. **42170**  
 EAN **4251269332616**  
 Package quantity **10**  
 Length **118 mm**  
 Width **56 mm**  
 Height **3 mm**  
 Mounting height **3 mm**

Cut-out size **86 × 36 mm**  
 No. of screw holes **4**  
 Diam. of screw holes **6 mm**  
 Colour **black**  
 Suitable for cable entry systems: **KEL 16, KEL-U 16, KEL-ER 16, KEL-QUICK 16**

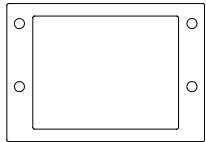
**Gasket 16-E**

Part No. **42142**  
 EAN **4251269332586**  
 Package quantity **1**  
 Length **118 mm**  
 Width **83 mm**  
 Height **3 mm**  
 Mounting height **3 mm**

Cut-out size **86 × 66 mm**  
 No. of screw holes **4**  
 Diam. of screw holes **6 mm**  
 Colour **black**  
 Suitable for cable entry systems: **KEL 16-E**

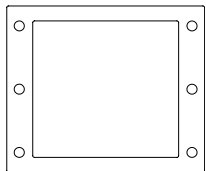
**Gasket 16-MT**

Part No. **42146**  
 EAN **4251269332593**  
 Package quantity **1**  
 Length **118 mm**  
 Width **100 mm**  
 Height **3 mm**  
 Mounting height **3 mm**

Cut-out size **86 × 82 mm**  
 No. of screw holes **6**  
 Diam. of screw holes **6 mm**  
 Colour **black**  
 Suitable for cable entry systems: **KEL 16-MT**

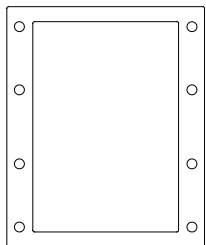
**Gasket 16-2MT**

Part No. **42150**  
 EAN **4251269332609**  
 Package quantity **1**  
 Length **118 mm**  
 Width **144,5 mm**  
 Height **3 mm**  
 Mounting height **3 mm**

Cut-out size **86 × 126 mm**  
 No. of screw holes **8**  
 Diam. of screw holes **6 mm**  
 Colour **black**  
 Suitable for cable entry systems: **KEL 16-2MT**

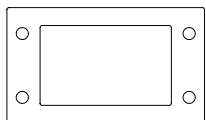
**Gasket 10**

Part No. **42257**  
 EAN **4251269332708**  
 Package quantity **10**  
 Length **98,3 mm**  
 Width **58 mm**  
 Height **2,5 mm**  
 Mounting height **2,5 mm**

Cut-out size **65 × 36 mm**  
 No. of screw holes **4**  
 Diam. of screw holes **6 mm**  
 Colour **black**  
 Suitable for cable entry systems: **KEL 10, KEL-U 10, KEL-ER 10, KEL-QUICK 10**

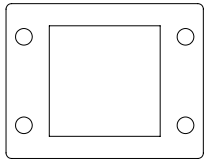
**Gasket B**

Part No. **42452**  
 EAN **4251269332746**  
 Package quantity **10**  
 Length **70,8 mm**  
 Width **56 mm**  
 Height **2,5 mm**  
 Mounting height **2,5 mm**

Cut-out size **46 × 46 mm**  
 No. of screw holes **4**  
 Diam. of screw holes **6 mm**  
 Colour **black**  
 Suitable for cable entry systems: **KEL-B, KEL-U-B, KEL-ER-B**

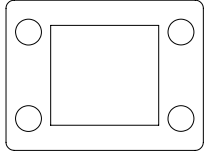
**Gasket QUICK-B**

Part No. **42451**  
 EAN  
 Package quantity **10**  
 Length **72,85 mm**  
 Width **55,6 mm**  
 Height **2,5 mm**  
 Mounting height **2,5 mm**

Cut-out size **46 × 46 mm**  
 No. of screw holes **4**  
 Diam. of screw holes **9,5 mm**  
 Colour **black**  
 Suitable for cable entry systems: **KEL-QUICK-B**

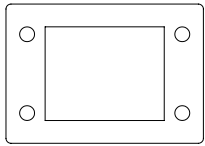
**Gasket FG-B**

Part No. **42331**  
 EAN **4251269332715**  
 Package quantity **1**  
 Length **72,85 mm**  
 Width **55,6 mm**  
 Height **2,5 mm**  
 Mounting height **2,5 mm**

Cut-out size **46 × 46 mm**  
 No. of screw holes **4**  
 Diam. of screw holes **9,5 mm**  
 Colour **black**  
 Suitable for cable entry systems: **KEL-FG-B, KEL-FG-ER B**

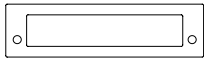
**Gasket E5**

Part No. **42251**  
 EAN **4251269332654**  
 Package quantity **10**  
 Length **147 mm**  
 Width **40 mm**  
 Height **2,5 mm**  
 Mounting height **2,5 mm**

Cut-out size **112 × 24 mm**  
 No. of screw holes **2**  
 Diam. of screw holes **6 mm**  
 Colour **black**  
 Suitable for cable entry systems: **KEL-E5, KEL-ER-E5, KEL-QUICK-E5, KEL-FG-E5, KEL-FG-ER E5, KEL-FL 4**

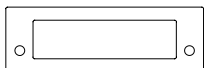
**Gasket E4**

Part No. **42198**  
 EAN **4251269332630**  
 Package quantity **10**  
 Length **120 mm**  
 Width **40 mm**  
 Height **2,5 mm**  
 Mounting height **2,5 mm**

Cut-out size **86 × 24 mm**  
 No. of screw holes **2**  
 Diam. of screw holes **6 mm**  
 Colour **black**  
 Suitable for cable entry systems: **KEL-E4, KEL-ER-E4, KEL-QUICK-E4, KEL-FL 3**

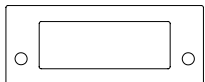
**Gasket E3**

Part No. **42197**  
 EAN **4251269332623**  
 Package quantity **10**  
 Length **98 mm**  
 Width **40 mm**  
 Height **2,5 mm**  
 Mounting height **2,5 mm**

Cut-out size **65 × 24 mm**  
 No. of screw holes **2**  
 Diam. of screw holes **6 mm**  
 Colour **black**  
 Suitable for cable entry systems: **KEL-E3, KEL-ER-E3, KEL-QUICK-E3, KEL-FG-E3, KEL-FG-ER E3, KEL-FL 2**

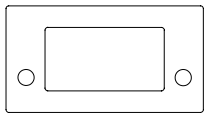
**Gasket E2**

Part No.	<b>42256</b>	Cut-out size	<b>43 × 24 mm</b>
EAN	<b>4251269332692</b>	No. of screw holes	<b>2</b>
Package quantity	<b>10</b>	Diam. of screw holes	<b>6 mm</b>
Length	<b>72,8 mm</b>	Colour	<b>black</b>
Width	<b>40 mm</b>	Suitable for cable entry systems:	<b>KEL-E2, KEL-ER-E2, KEL-QUICK-E2, KEL-FG-E2, KEL-FG-ER E2, KEL-FL 1</b>
Height	<b>2,5 mm</b>		
Mounting height	<b>2,5 mm</b>		

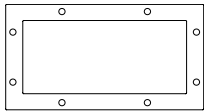
**Gasket 183**

Part No.	<b>47110</b>	No. of screw holes	<b>8</b>
EAN	<b>4251269332753</b>	Diam. of screw holes	<b>7 mm</b>
Package quantity	<b>1</b>	Colour	<b>black</b>
Length	<b>220 mm</b>	Suitable for cable entry systems:	<b>KEL 183</b>
Width	<b>118 mm</b>		
Height	<b>2,5 mm</b>		
Mounting height	<b>2,5 mm</b>		

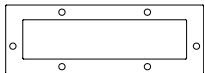
**Gasket 183-E**

Part No.	<b>47111</b>	No. of screw holes	<b>6</b>
EAN	<b>4251269332760</b>	Diam. of screw holes	<b>7 mm</b>
Package quantity	<b>1</b>	Colour	<b>black</b>
Length	<b>220 mm</b>	Suitable for cable entry systems:	<b>KEL 183-E</b>
Width	<b>77 mm</b>		
Height	<b>2,5 mm</b>		
Mounting height	<b>2,5 mm</b>		

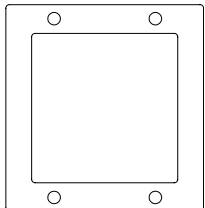
**Gasket JUMBO 1**

Part No.	<b>42361</b>	No. of screw holes	<b>4</b>
EAN	<b>4251269332739</b>	Diam. of screw holes	<b>7 mm</b>
Package quantity	<b>1</b>	Colour	<b>black</b>
Length	<b>110,3 mm</b>	Suitable for cable entry systems:	<b>KEL-JUMBO 1</b>
Width	<b>116,3 mm</b>		
Height	<b>2 mm</b>		
Mounting height	<b>2 mm</b>		

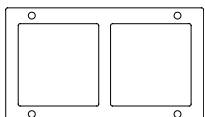
**Gasket JUMBO 2**

Part No.	<b>42351</b>	No. of screw holes	<b>4</b>
EAN	<b>4251269332722</b>	Diam. of screw holes	<b>7 mm</b>
Package quantity	<b>1</b>	Colour	<b>black</b>
Length	<b>200,3 mm</b>	Suitable for cable entry systems:	<b>KEL-JUMBO 2</b>
Width	<b>116,3 mm</b>		
Height	<b>2 mm</b>		
Mounting height	<b>2 mm</b>		